

Domus Houthaven

co-living complex

Assignment

Architectural design and engineering, interior design

Year

2017-

Status

Under Construction

Client

Synchroon BV

Location

Amsterdam, NL

Program

235 apartments, commercial and communal facilities

Project team

Oana Radeş
 Thijs van Bijsterveldt
 Harm Timmermans
 Paul Voorbergen
 Marinda Verschoor
 Philip de Klerk
 Elise Oosterloo
 Martyna Drys

Technical advisor

ABT

Landscape

Flux

Contractor

Van Wijnen Haarlemmermeer

Facility Office

LMV bouwkundig

Brand Identity

...,staat



The increasing popularity of inner-city living and the changing mentality regarding sustainability, ownership and lifestyle open the door for a new inner-city residential typology: the micro-apartment. Micro-apartment complexes offer opportunities for sustainable urban densification at various levels.

The growing group of one- and two-person households, the primary focus of micro-apartments, values ownership less and is more willing to share. They use the city as a second living room and exchange the car for a car sharing subscription. By sharing other facilities and installations (e.g. collective energy generation or a communal laundry, etc) across multiple users, efficiency advantages arise. Proximity to urban facilities is high on the list of housing requirements, reducing traffic movements and car mobility. More importantly, micro-apartment complexes allow various groups of people to continue to live in the inner-city, maintaining the city a dynamic and attractive place for now and in the future.

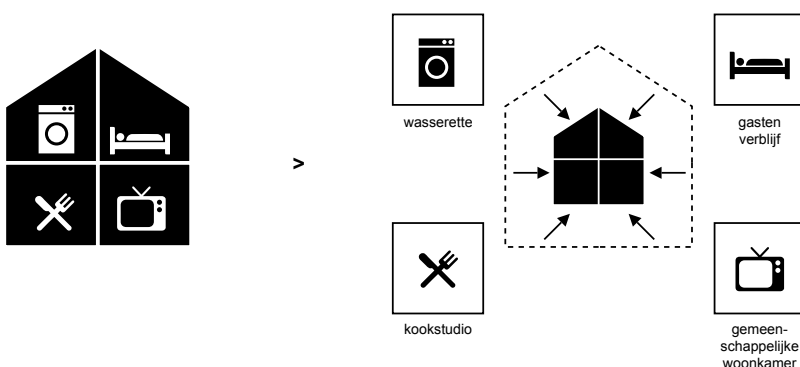

By accommodating certain residential functions in collective facilities, the home itself can become more compact

Shift architecture
urbanism

Nieuwe Binnenweg 77b
 3014 GE Rotterdam
 +31 10 414 01 81
 www.shifta.nl
 info@shift-au.com

**Domus
Houthaven**
co-living complex

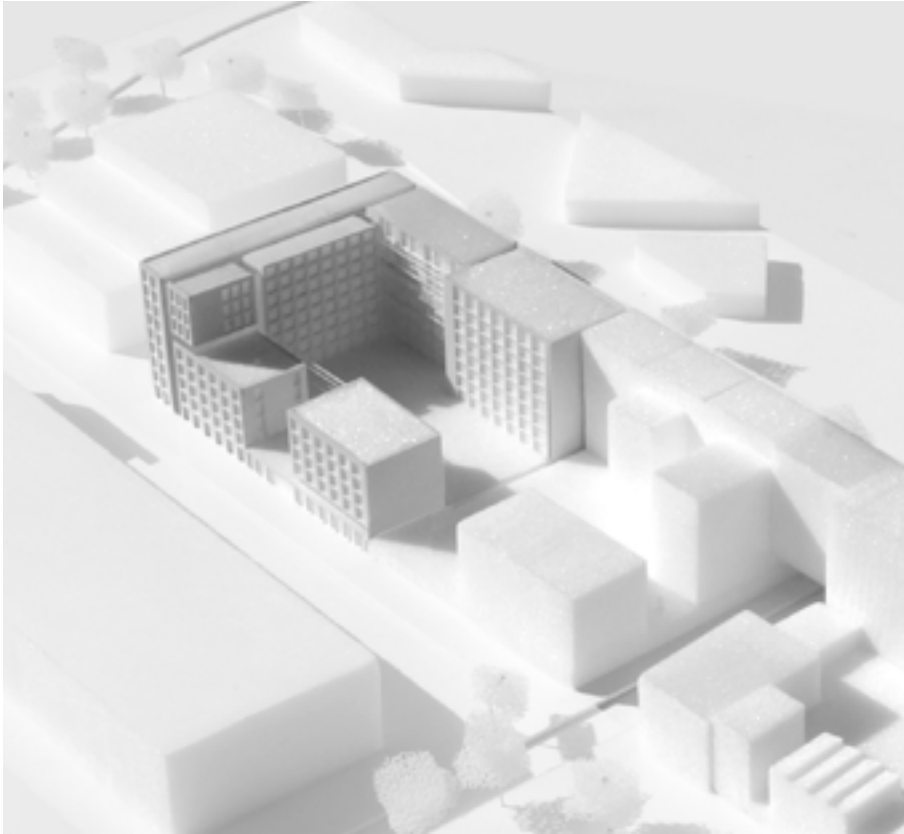

location in the Houthaven

XS Deluxe Houthaven features 235 apartments in a family of buildings grouped around a collective green courtyard. Each building volume has a specific grain size, materialization and apartment typology. Their individual appearance fosters identification of the residents with their home within the vast complex and brings the project back to a scale that matches the characteristic grain size of Houthaven.



characteristic street view of Houthavenkade



view from Haparandaweg

Shift *architecture
urbanism*

Nieuwe Binnenweg 77b
3014 GE Rotterdam
+31 10 414 01 81
www.shifta.nl
info@shift-au.com

**Domus
Houthaven**
co-living complex



details block 2 and 3



view from Houthavenkade



plan deck level

Shift architecture
urbanism

Nieuwe Binnenweg 77b
3014 GE Rotterdam
+31 10 414 01 81
www.shifta.nl
info@shift-au.com

The green courtyard and the roof terrace on the fifth floor form the collective heart of the complex. Around it are positioned the collective living room, wasserette, library, guest house and cooking studio, which can be used by all residents. The building plinth offers room for public facilities for the neighborhood and for work units that can be connected to the apartments on the first floor. The parking garage offers space for a shared-vehicle concept.

Domus Houthaven

co-living complex



view from the deck



interior design elements common space

Shift *architecture
urbanism*

Nieuwe Binnenweg 77b
3014 GE Rotterdam
+31 10 414 01 81
www.shifta.nl
info@shift-au.com

**Domus
Houthaven**
co-living complex



common livingroom



kitchen area common livingroom



lounge area common livingroom

Shift *architecture
urbanism*

Nieuwe Binnenweg 77b
3014 GE Rotterdam
+31 10 414 01 81
www.shifta.nl
info@shift-au.com

The apartments vary between 40m2 and 60m2. Each of them features an XL cabinet containing the kitchen, bathroom, storage and the bed alcove, while the rest of the space is open and flexible to be adapted to the desires of the inhabitant. The rich mix of apartment typologies, catering to many different life styles, together with the wide range of shared facilities make the complex into a differentiated and vibrant piece of city.

**Domus
Houthaven**
co-living complex

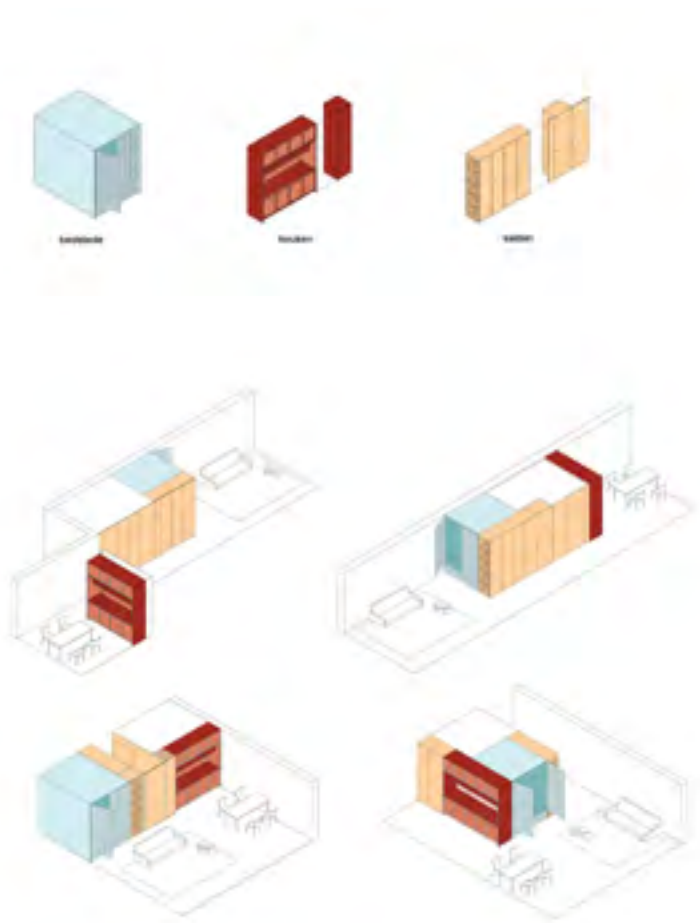

interior design concept apartements

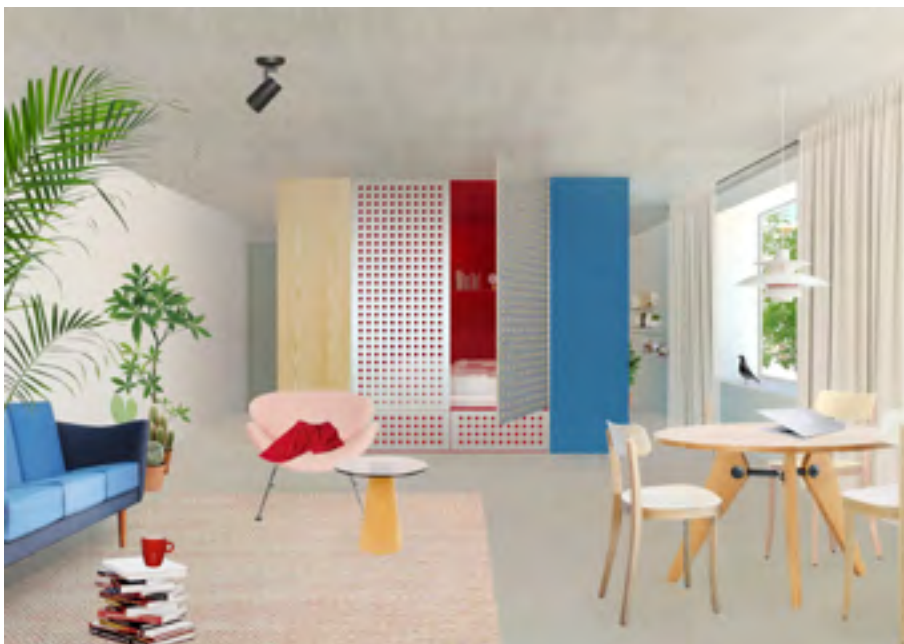

Shift architecture
urbanism

Nieuwe Binnenweg 77b
3014 GE Rotterdam
+31 10 414 01 81
www.shifta.nl
info@shift-au.com

**Domus
Houthaven**
co-living complex



Shift architecture
urbanism

Nieuwe Binnenweg 77b
3014 GE Rotterdam
+31 10 414 01 81
www.shifta.nl
info@shift-au.com